

REMOVAL

CAUTION:

Do not smoke or work near an open flame when working the fuel pump.

1. REMOVE FUEL TANK (See page [SF-25](#))
2. DISCONNECT FUEL MAIN TUBE AND RETURN TUBE FROM FUEL TANK

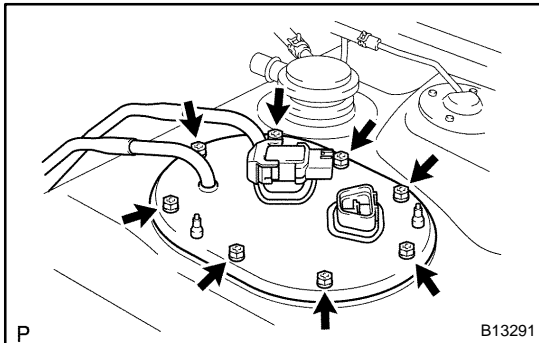

3. REMOVE FUEL PUMP AND SENDER GAUGE ASSEMBLY FROM FUEL TANK

- (a) Remove the 8 bolts.
- (b) Pull out the fuel pump and sender gauge assembly.

NOTICE:

- Do not damage the fuel pump filter.
 - Be careful not to bend the arm of the sender gauge.
- (c) Remove the gasket from the fuel section plate.

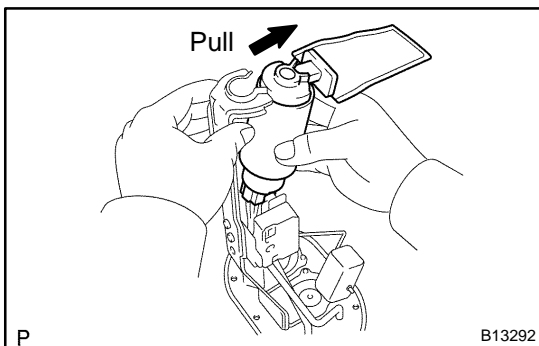

4. REMOVE FUEL PUMP FROM FUEL PUMP BRACKET

- (a) Disconnect the lead wire from the connector of the fuel sustion plate.
- (b) Pull out the lower side of the fuel pump from the pump bracket.
- (c) Disconnect the fuel hose from the fuel pump, and remove the fuel pump.
- (d) Remove the rubber cushion from the fuel pump.

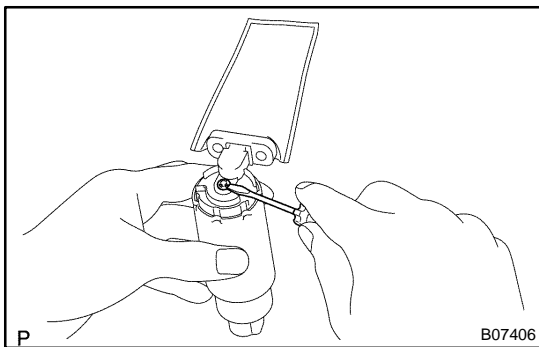

5. REMOVE FUEL PUMP FILTER FROM FUEL PUMP

- (a) Using a small screwdriver, remove the clip.
- (b) Pull out the pump filter.